

THE FOLLOWING SECTION IS FOR TOWN OFFICIAL REVIEW & SIGNATURES

PROPERTY LOCATION / STREET ADDRESS

146 MOUNTAIN Rd

AGENT SECTION

In reviewing and approving any application for a permit, the Town officer shall determine that the following provisions have been met:

- The application is complete and the applicable fee has been paid.
- All applicable regulations have been met or varied by the modification process.
- Modification: N/A Approved Denied
- Extension: N/A Granted Denied Expiration Date: ___ / ___ / ___

OTHER APPROVALS REQUIRED

To demonstrate that the proposal complies with local Inland Wetlands, Health District and Public Works requirement, the following approvals may be required and any conditions of approval shall be incorporated into the permit:

****MUST NOTIFY HEALTH DIRECTOR IF CUTTING OR FILL IS 12" OR GREATER****

| | | |
|---------------------------------|------|----------|
| DIRECTOR OF HEALTH N/A | DATE | COMMENTS |
| INLAND WETLAND AGENT N/A | DATE | COMMENTS |
| DIRECTOR OF PUBLIC WORKS N/A | DATE | COMMENTS |

FINAL ACTION FOR PERMIT

Based on the applicant's submissions which are attached to or referenced on this form, the permit has been:

- Approved as submitted.
- Approved with modification or conditions as stated below.
- Denied.

The following comments, condition(s) of approval or reason(s) for denial apply:

NO KNOWN OR OBSERVABLE TRAFFIC SAFETY PROBLEMS EXIST AT THIS TIME. PLAN AS SUBMITTED INDICATES COMPLIANCE WITH THE ORDINANCE

AUTHORIZED AGENT:

SIGNATURE

DATE

7/27/10

SITE MAP / 46 MOUNTAIN ROAD

PROPERTY LINE

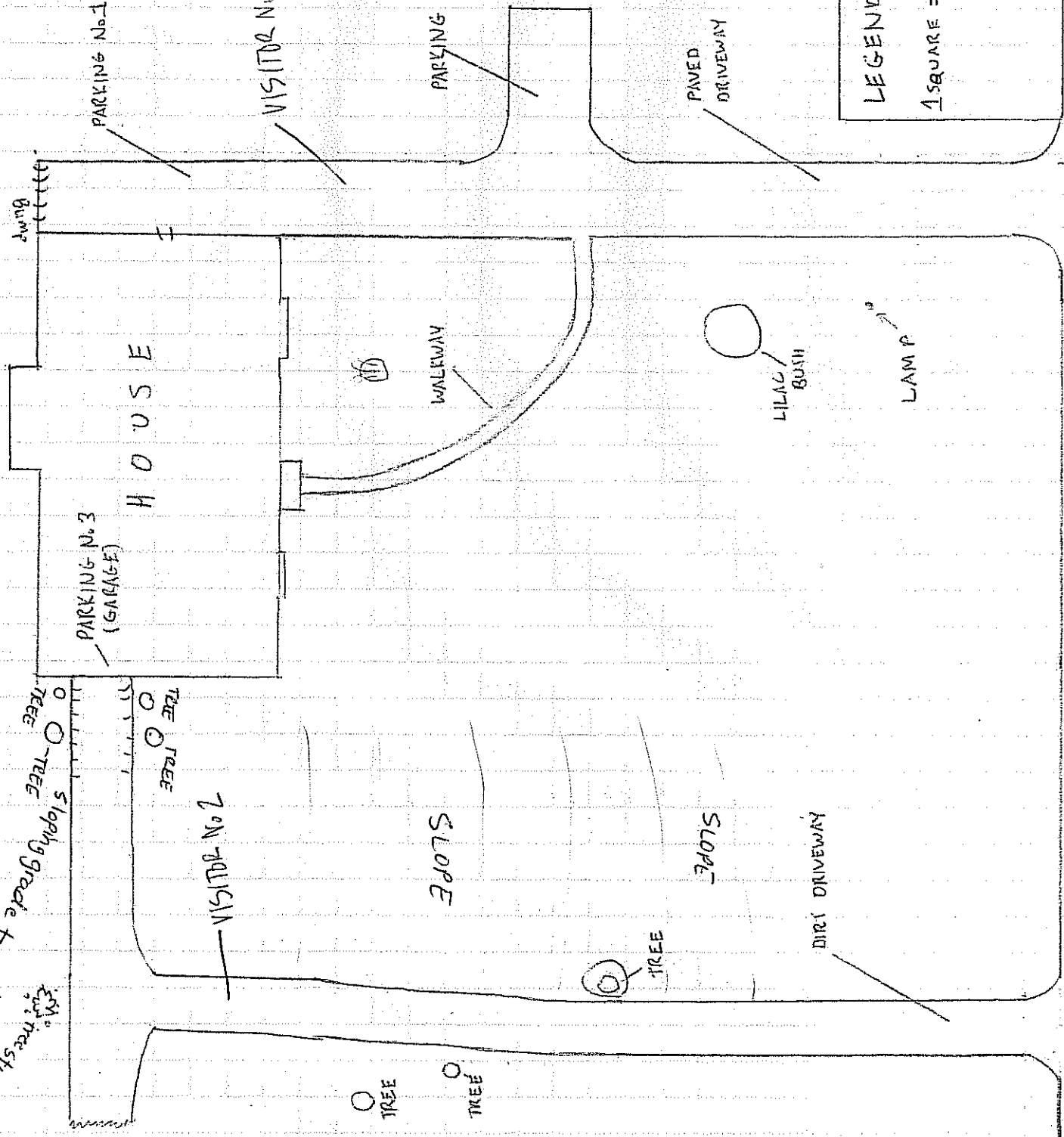

LEGEND
 1 SQUARE = 5 FEET

Bump

PARKING No. 3 (GARAGE)

HOUSE

WALKWAY

PAVED DRIVEWAY

CLUB ROOM

PARKING No. 1

VISITOR No. 1

LAMP

LILAC BUSH

SLOPE

SLOPE

DIRT DRIVEWAY

VISITOR No. 2

TREE

TREE

TREE

TREE

TREE

TREE

TREE

Sloping grade to LL garage

EMC tree stamp

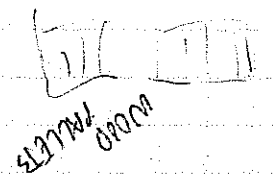

WOOD WALLS