

THE FOLLOWING SECTION IS FOR TOWN OFFICIAL REVIEW & SIGNATURES

PROPERTY LOCATION / STREET ADDRESS

52 SPRING HILL

AGENT SECTION

In reviewing and approving any application for a permit, the Town officer shall determine that the following provisions have been met:

- The application is complete and the applicable fee has been paid.
- All applicable regulations have been met or varied by the modification process.
- Modification:** N/A Approved Denied
- Extension:** N/A Granted Denied Expiration Date: ___ / ___ / ___

OTHER APPROVALS REQUIRED

To demonstrate that the proposal complies with local Inland Wetlands, Health District and Public Works requirement, the following approvals may be required and any conditions of approval shall be incorporated into the permit:

****MUST NOTIFY HEALTH DIRECTOR IF CUTTING OR FILL IS 12" OR GREATER****

DIRECTOR OF HEALTH	DATE	COMMENTS
INLAND WETLAND AGENT	DATE	COMMENTS
DIRECTOR OF PUBLIC WORKS	DATE	COMMENTS

FINAL ACTION FOR PERMIT

Based on the applicant's submissions which are attached to or referenced on this form, the permit has been:

- Approved as submitted.
- Approved with modification or conditions as stated below.
- Denied.

The following comments, condition(s) of approval or reason(s) for denial apply:

Approved without barriers due to no history of parking issues.

AUTHORIZED AGENT:

SIGNATURE

Bob Freeman

DATE

11/6/12



Town of Mansfield, Connecticut
Geographic & Property Information Application

Full Extent Reset Map Search Print Map Help

SELECT TOWN

Map Layers

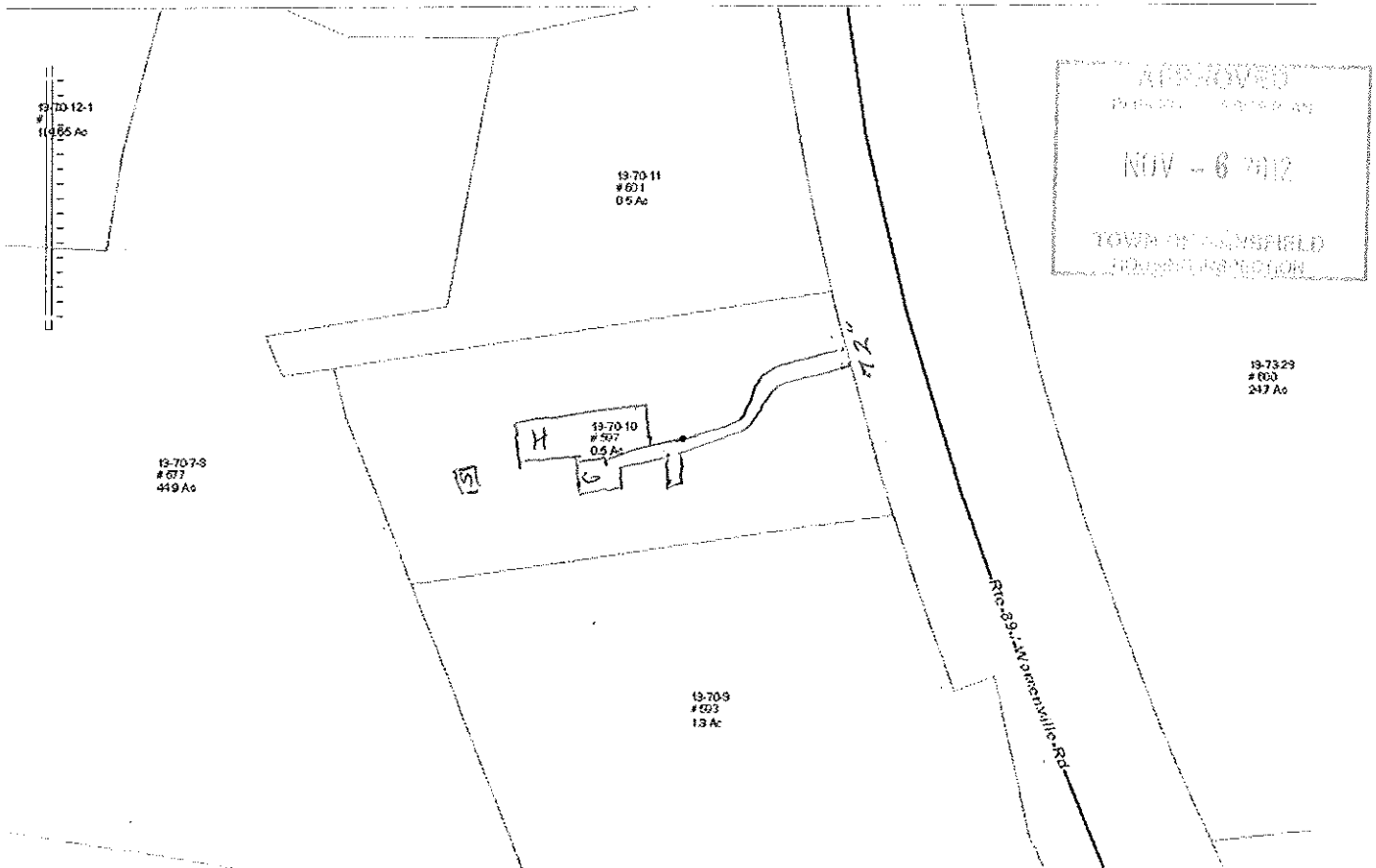

Full Extent Zoom In Zoom Out Prev Extent Next Extent Pan Parcel Information Simple Measure Path Measure Area Measure

MapXpress v1.2

Scale: 1 in = 50 ft

CT State Plane NAD 1983

10/16/12

Derek, Any questions I am off to Cabo, Mexico just call me at 860-377-4694 with any questions.

Thank you for all your help,
Carol

Septic & water will be sent when I get back ...